

**Bestuhlungsplan Auditorien 1 & 2 GZI (532m<sup>2</sup>)**

Bankett (Auditorium 1 & 2)

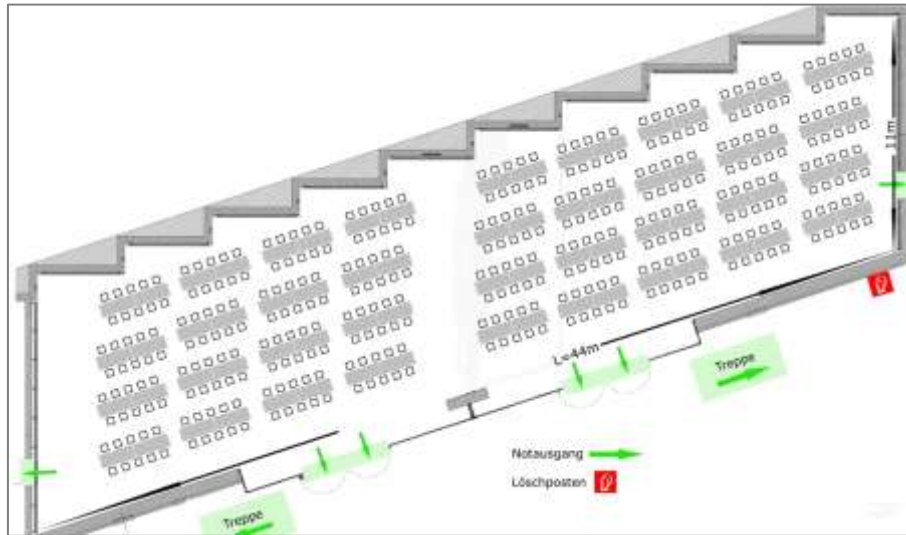

Seminar (Auditorium 2)

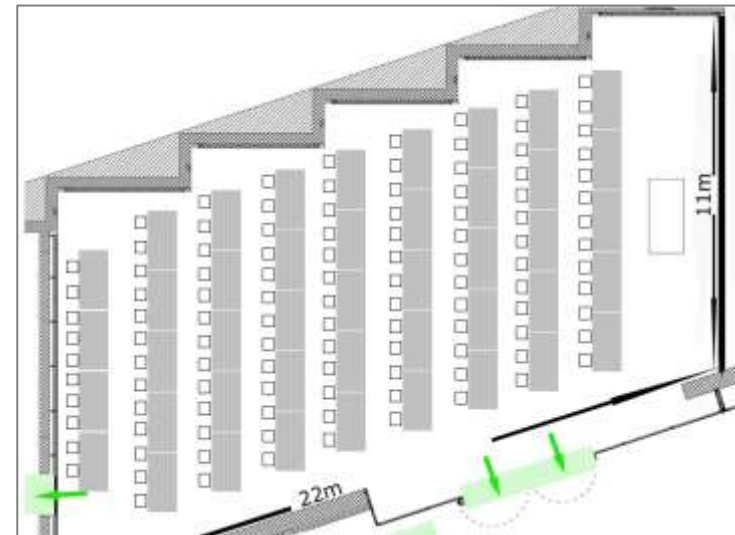

Seminar & Konzert (Auditorium 1 & 2)

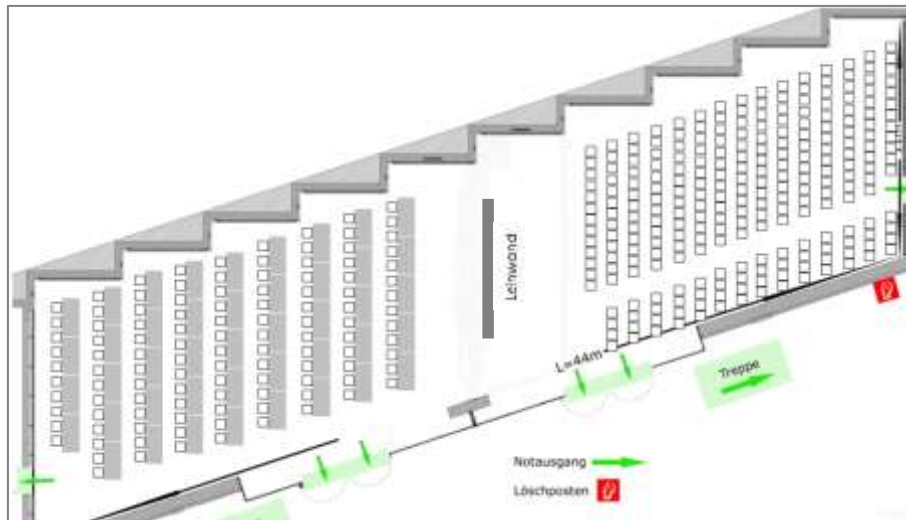

|   |     |
|---|-----|
| Anzahl Plätze:                              |     |
| Auditorien 1 & 2 (532m <sup>2</sup> )       |     |
| Seminar                                     | 222 |
| Konzert                                     | 368 |
| Bankett                                     | 408 |
| Auditorium 1 oder 2 (je 266m <sup>2</sup> ) |     |
| U-Form                                      | 48  |
| Seminar                                     | 114 |
| Konzert                                     | 250 |
| Bankett                                     | 228 |

**SEMINARE EVENTS GENUSS**